



ENTEGR A
COACH®

2 0 1 0
CORNERSTONE



Redefining Luxury





ENTEGRA
COACH®

Raise Your Expectations.

Class-leading luxury for motorcoach owners who know what they want from the company that understands what they deserve.

Entegra Coach proudly brings you the Cornerstone. Thoughtfully designed with the superior quality of Amish handcrafted hardwoods, the Cornerstone features solid granite countertops with beveled edges, exquisite international fabrics and high-gloss porcelain tile flooring with four-inch granite inlays. The Cornerstone brings new meaning to luxury and elegance.



Designed for the two of you. Shown here (on the 45RB model) are two porcelain sinks, sprawling solid granite countertops with space for his and her toiletries and heated granite flooring. You can also unwind and relax in the Cornerstone's radius shower with its beautiful handlaid porcelain and granite tile surround.



Cornerstone's bedroom offers a heavenly night's sleep on a King Select Comfort™ air mattress. While you sleep, your clothing is treated to a mirrored and cedar-lined, carpeted wardrobe. Sweet dreams!

LUXURY + INNOVATION + PASSION = CORNERSTONE

Refined. Elegant. Luxurious. This is the Cornerstone. You know the word:

"A foundation. Fundamentally important. What life's all about." From entertaining with the ultimate in hospitality to extraordinary traveling in exceptional comfort. Like a sumptuous driver's compartment with a natural distressed leather captain chair and buddy seat with heated electric 8-way power seats and integrated seat belts. Cornerstone is transforming the motorhome experience with distinctive taste, flair and the ultimate in elegant luxury. Let this Entegra Coach be the foundation of your traveling pleasure.



Luxurious details in the granite countertops, porcelain sinks, nickel faucets and Washington Cherry Glazed Maple hardwood.

Multiplex™ coach switching puts the control of living area, porch and security lighting at your fingertips.

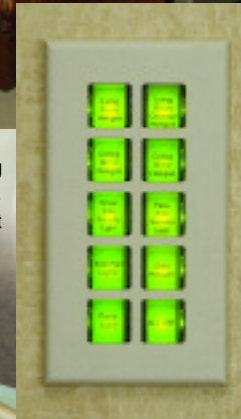

While the 40-inch LCD HDTV with home theater surround sound comes standard. Add in the optional electric fireplace, which is perfect for setting the mood on chilly evenings.





1. Ultra-Vision™ wrap around one-piece windshield
2. X-Bridge™ frames engineered into the chassis
3. Aluma-Tru™ superstructure construction on 16" Centers
4. Daytime running lights
5. Premium full-body paint package
6. Extra large basement storage
7. Side-hinged baggage doors
8. (2) Slideout storage trays
9. Frameless tinted dual pane safety glass windows
10. Flush mounted slideout rooms
11. Rear molded fiberglass cap with high mounted integrated air intake
12. Porcelain tile with 4" inlays granite throughout
13. Steel tubular floor joists
14. Wood truss floor risers

15. Floor & underbelly fiberglass and Flexfoil® insulation (R-33)
16. 5/8" tongue-and-groove plywood floor decking
17. 1/2" foam insulation laminated to sidewall
18. Reflective Flexfoil® insulation on all 6 sides
19. Sidewall fiberglass and Flexfoil® insulation (R-16)
20. Lauan board
21. Hi-gloss gel-coat fiberglass exterior
22. Front molded fiberglass cap
23. Welded crowned aluminum truss rafters 16" on center
24. Roof fiberglass and Flexfoil® insulation (R-24)
25. 3/8" plywood roof decking
26. Seamless fiberglass roof
27. (3) 15,000-BTU low-profile roof A/C with heat pumps and drain tubes
28. Vinyl padded ceiling
29. Entry door with air seal



If you haven't experienced a Fisher/Paykel® dishwasher drawer, prepare to be spoiled. A giant leap of innovation over traditional dishwashers, the quiet-running dishwasher drawer turns luxury into a necessity.

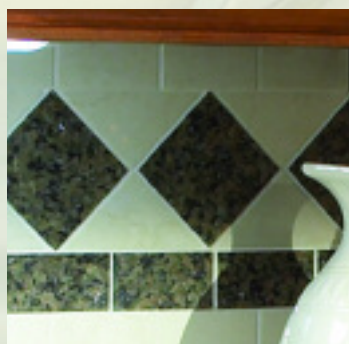

An example of our design team's attention to detail: Decorative granite inlays in the solid porcelain back-splash above the stunning, yet oh-so-easy to care for, granite countertop.



For the ultimate in power, the Cornerstone is built on a Spartan® K2 tag axle chassis with a Cummins® ISM 500 HP electronic engine featuring an Allison® 4000 MH six-speed World transmission and electronic shifter. For maximum power, upgrade to the Spartan® K3 chassis with the Cummins® ISX 650HP (N/A 45RB).



Exclusive to Entegra Coach products, the X-Bridge™ frames are designed and engineered especially for the Cornerstone chassis, providing superior support and stabilization.

HELLO, GORGEOUS!

From the moment you set eyes on this beauty, you'll know. This is the Class A diesel pusher meant for you. From its smooth hi-gloss gel-coat fiberglass exterior and one-piece molded fiberglass roof and caps to the stunning graphics on the deluxe, full-body paint package that is so meticulously done it takes nearly two weeks to complete.

Choose from White Diamond Pearl (shown here), Black Pearl, Mystic Black, Molten Metal or Golden Splendor. And note the frameless tinted dual-pane safety windows and one-piece wrap-around Ultra-Vision™ windshield. On the road again? Oh yes.



Cornerstone
by ENTERTAINMENT



Large round LED exterior running lights and taillights are brighter and easier to see – a safeguard for you and other motorists.



An exterior entertainment center with a 32-inch LCD HDTV, speakers and DVD player – to entertain the kid in all of us.



Two huge carpeted, lighted slide-out cargo trays provide storage space for outdoor furniture, grills, coolers, luggage and sporting gear. Add power for ultimate convenience.



Exterior Graphic, Fabric & Wood Choices



White Diamond Pearl



Golden Splendor



Molten Metal



Mystic Black



ENTEGRA
COACH®



Black Pearl



Washington Cherry Glazed Maple



Caramel Glazed Maple



Caviar



Champagne



Manhattan

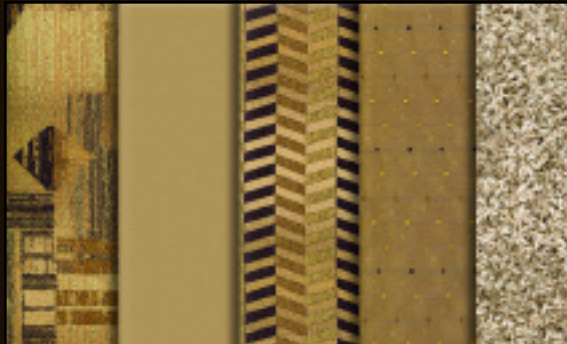

Cashmere

DETAILS MAKE THE CORNERSTONE DIFFERENCE

We use only the highest quality solid hardwoods (shown here in Caramel Glazed Maple), carefully hand hewn by Amish craftsmen. From interior doors to slideout fascia, from cabinetry and drawers to crown molding and sconces, all are fashioned by craftsmen who have an eye for beauty and elegance.



Thoughtful attention to detail is evident throughout the Cornerstone. All windows are outfitted with solid hardwood valances, fine décor-coordinated fabrics (shown here in Champagne) and day/night power roller shades to ensure your privacy.

Floorplans

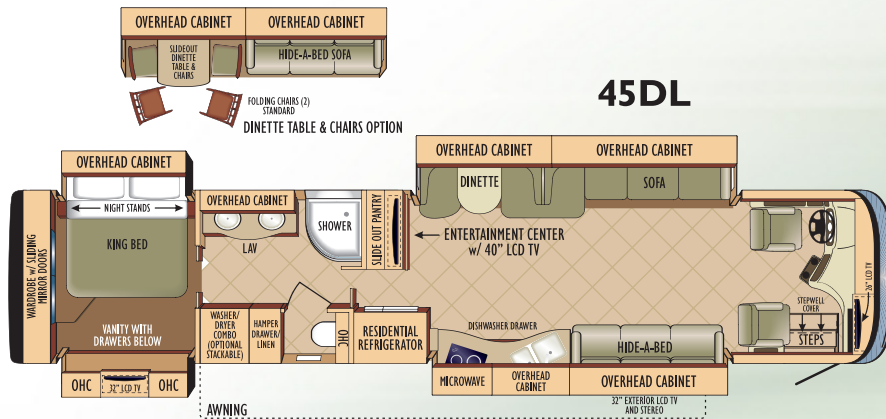

CORNERSTONE 45DL

GVWR (lbs.)	46,600
GCWR (lbs.)	61,600
Front GAWR (lbs.)	16,600
Rear GAWR (lbs.)	20,000
Tag Axle GAWR (lbs.)	10,000

Wheelbase	320"
Overall Length	44' 11"
Overall Height w/Air & Satellite	13' 5"
Exterior Width	101"
Interior Headroom	84"

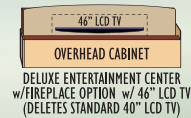

Tank Capacities	
Fresh water (gals.)	100
Grey water (gals.)	60
Black water (gals.)	60

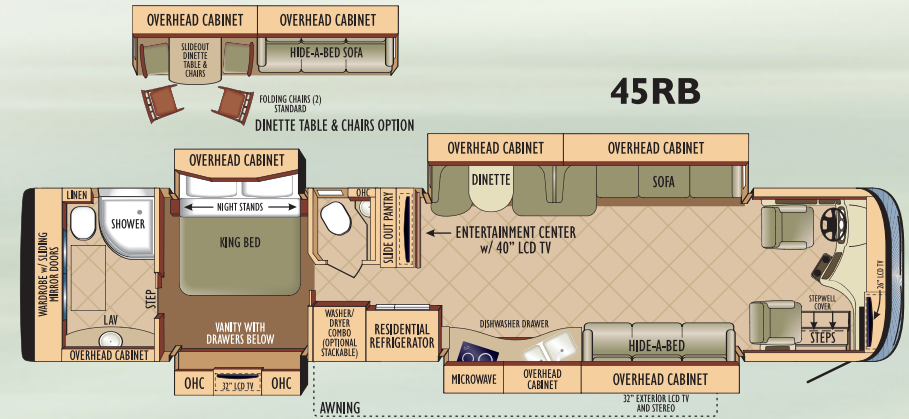

CORNERSTONE 45RB

GVWR (lbs.)	46,600
GCWR (lbs.)	61,600
Front GAWR (lbs.)	16,600
Rear GAWR (lbs.)	20,000
Tag Axle GAWR (lbs.)	10,000

Wheelbase	320"
Overall Length	44' 11"
Overall Height w/Air & Satellite	13' 5"
Exterior Width	101"
Interior Headroom	84"

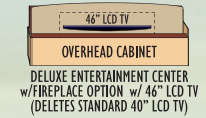

Tank Capacities	
Fresh water (gals.)	100
Grey water (gals.)	60
Black water (gals.)	60

Gross Vehicle Weight Rating (GVWR): GVWR means the maximum permissible weight of the motorhome, including the unloaded vehicle weight plus passengers, personal items, all cargo, fluids, options and dealer-installed accessories.

Gross Combined Weight Rating (GCWR): The maximum allowable combined weight of the motorhome used as a tow vehicle and the attached towed vehicle.

Gross Axle Weight Rating (GAWR): The maximum allowable weight each axle assembly is designed to carry, as measured at the tires, therefore including the weight of the axle assembly itself.

It is important for your safety and enjoyment that you are aware of the weights and tow ratings of the RV you select. Consult a competent advisor if you have questions. Whether you are new to RVing or a veteran, get a feel for the performance of your RV before heading out on the roadways. When you tow a vehicle with your RV, you must drive differently than when you drive a single vehicle. Practice hooking up, driving, backing up and braking in a safe environment or seek our professional instruction. Entegra Coach affixes a weight label to each RV which lists weight information for that vehicle. Refer to that label to verify the vehicle will meet your requirements.



CORNERSTONE 45SL

GVWR (lbs.)	46,600
GCWR (lbs.)	61,600
Front GAWR (lbs.)	16,600
Rear GAWR (lbs.)	20,000
Tag Axle GAWR (lbs.)	10,000

Wheelbase	320"
Overall Length	44' 11"
Overall Height w/Air & Satellite	13' 5"
Exterior Width	101"
Interior Headroom	84"

Tank Capacities	
Fresh water (gals.)	100
Grey water (gals.)	60
Black water (gals.)	60

Standards & Options

CONSTRUCTION HIGHLIGHTS

2" x 4" floor trusses
2-3/4" welded tubular-aluminum sidewall construction
3M® front protective film mask
4-1/2" arched aluminum truss roof (R-24)
5/8" tongue-and-groove plywood main floor decking
Aluma-Tru™ Superstructure construction on 16" centers
Cabinetry crafted with screwed hardwood stile construction
Deluxe hidden cabinet hinges
Electric-powered slideout
Enclosed, insulated and heated floor and underbelly (R-33)
Flush-mounted slideout rooms
Fully-decked roof with 3/8" plywood
One-piece fiberglass roof
Polar Pack insulation with reflective flexfoil floor (R-33), roof (R-24), sidewalls (R-16)
Sidewalls bolted to frame
Smooth high-gloss gel-coat fiberglass exterior walls
X-Bridge™ frames engineered into the chassis

CHASSIS, ENGINE & SUSPENSION

2 chassis batteries
4.33:1 "Quiet-Gear" rear axle ratio
55-degree turning radius
150-gal. fuel tank (dual fill)
200 amp alternator
15,000-lb. hitch with 7-pin plug
Allison® GEN 4 - 4,000MH 6-speed shift pad electronic transmission
All-wheel ABS brakes
Automatic heated moisture ejectors
Automatic Traction Control (ATC)
Bilstein® hydraulic shocks (front/rear)
Cummins® ISM 10.8 liter, turbocharged 500 HP engine
1,550 lb. ft. torque @ 1,200 RPM
Day time running lights
Engine block heater
Engine compression brake
Full-Air front disc and rear drum brakes
Hendrickson HTB™ rear air suspension
Meritor® rear axle 20,000-lbs., tag axle 10,000 lbs.
Michelin® 315/80R 22-1/2" radial tires
Polished aluminum wheels
Pre-wired for supplemental braking system
Raised rail for maximum storage
Remote air fill with air hose
Side-mounted radiator
Spartan® K2® tag axle chassis
Tag axle auto weight release
Tuthill IFS 16,600 front axle wide track
Tuthill IFS independent front air suspension
VIP soft touch, wood grain, leather-wrapped steering wheel

DRIVER COMPARTMENT AMENITIES

12V auxiliary in-dash receptacle (2)
26" digital LCD HDTV
AC/heater vents by foot pedals
Adjustable foot pedals
Auxiliary start switch
Battery boost switch
CB radio with antenna
Chassis battery disconnect
Color back-up camera and monitor with audio
Color coordinated carpeted floor mats
Cruise control (VIP Smart wheel controlled)
Dual air horns
Fog lights
High-gloss porcelain tile with 4" granite inlays

High-output dual-zone dash heater and A/C
In-dash compass and exterior temperature gauge
Intermittent windshield wipers, single motor (VIP Smart wheel controlled)
Touch-screen AM/FM/CD/DVD with Garmin® navigation and Bluetooth® with media and phone integration capability
Natural distressed leather power adjustable driver and passenger seats with integrated 3-point, lap and shoulder safety belts
Powered roller side sun visors and privacy shades
Powered roller windshield sun visors and privacy shades
Powered stepwell cover with pinch resistance technology
Push button shift control
Side cameras with turn signals
Sirius® satellite radio
Spartan™ Message Center with LCD display featuring: odometer, tachometer, instantaneous fuel economy, fuel remaining, outside air temp., coolant temp., engine oil temp. and pressure, transmission temp., turbo boost pressure, air pressure, diagnostic functions, fault codes, service reminders, percentage of engine load, trip meter, speed and voltage

Storage compartment(s) beside passenger seat
Tilt and telescoping steering column
Touch control for hydraulic automatic leveling jack system
Trip-Tek Information Center
Ultra-Vision™ one-piece wraparound tinted windshield
VIP Smart steering wheel integrated controls for systems

INTERIOR/ENTERTAINMENT

2-panel residential-style solid hardwood passage doors throughout
40" LCD HDTV in living area
All-in-one home theater remote
Cable TV hookup with RG6 coax
Central vacuum system
Combo washer/dryer
Decorative pillows for hide-a-bed
Decorative satin nickel lighting throughout
Decorative trim package
Designer ceiling mirror feature
Fabric and wood-covered box valances with lambrequin legs
Hardwood cabinets
Hardwood fascia boards
High-gloss porcelain tile with 4" granite inlays
High-intensity halogen recessed 12V lighting package
Home theater system, Dolby® Digital 5.1 Surround Sound with DVD
In-motion roof-mounted satellite dome (HD-ready)
Lights at entrance steps
Lining on cabinet shelves
Natural distressed leather booth dinette/comfort lounge sofa ensemble
Natural distressed leather hide-a-bed sofa
Padded vinyl ceiling throughout
Phone jack
Power day/night roller shades throughout
Power digital HDTV antenna with signal booster
Residential-style trim and molding
Washington Cherry Glazed Maple solid hardwood cabinetry and mitered corner raised-panel doors throughout

KITCHEN

120V G.F.C.I. protected receptacle
Fisher/Paykel® dishwasher drawer
High-rise satin nickel dual-lever faucet
High-gloss porcelain tile backsplash with granite inlays
High-gloss porcelain tile floor in kitchen with 4" granite inlays
Jenn-Air® 22 cu. ft. 2-door residential refrigerator with in-door ice and water dispenser
Jenn-Air® 1.6-cu. ft. convection microwave oven with carousel
Jenn-Air® flush-mounted, electric 2-burner touch control range
Mini blind

Silverware drawer, divided for utensils
Solid granite residential-grade countertops with undermounted stainless-steel sink
Solid granite sink covers/cutting boards (4)
Under-sink, sink cover storage compartment

BATHROOM

2-panel residential-style solid hardwood passage doors
120V G.F.C.I. protected receptacle
Bathroom power vent with rain sensor and remote control
High-gloss porcelain tile with 4" granite inlays
Overhead cabinet above stool
Radius-glass shower door with granite tile backsplash
Residential medicine cabinet with mirror
Satin nickel fixtures
Skylight in shower
Solid granite residential-grade countertops with porcelain sink
Thetford® Aria™ porcelain stool with push-button flush
Toilet paper holder
Towel holder and ring
Vanity light fixture
Window in commode area

BEDROOM

32" digital LCD HDTV
All-in-one home theater remote
Decorative headboard
Designer ceiling mirror feature
Halogen satin nickel reading lights
Home theater system, Dolby® Digital 5.1 Surround Sound with DVD
King Select Comfort™ air mattress
Large cedar-lined wardrobe
Quilted bedspread with 2 pillow shams

EXTERIOR

32" LCD HDTV and 12V AM/FM/CD/DVD player in exterior doorside sidewall
120V G.F.C.I. protected exterior receptacle
Aerodynamic fiberglass front cap
Carefree® armored slideout awnings
Carefree® armored power entrance door awning
Carefree® armored power window awnings
Carefree® roof-integrated, armored, and powered roof awning
Chrome, heated, remote-control, side-view mirrors
Docking lights
Door for dump valve access
Electric-powered, double entrance step
Entry door with powered air seal technology
Frameless dual-pane tinted safety-glass windows
Full-body premium paint package
Full-width rear mudflap
Hydraulic automatic leveling jacks (dual positive)
Keyless entry key FOB and keypad system
Lighted heavy-duty grab handle
One-piece pass-through storage compartments with Tuff-ply™ durable lining
Patio light with inside switch
Power baggage door locks with key fob
Rear molded fiberglass cap with integrated rear intake
Security lights (2)
Side-hinged baggage doors
Slideout cargo trays (2)
Sliding battery tray (2 position)
Uni-Dock™ exterior utility center, heated and enclosed with second system monitor panel
Winegard® In-Motion dome satellite dish.
Xenon low beam headlights

HEAT, POWER & WATER

(2) 2,800-watt inverters with 8-6V batteries
5-watt solar panel (for chassis batteries)
12V demand water pump
12V electrical system
50-amp electric service
50-amp, quick-connect power cord with electric reel
Aqua-Hot™ 450 water and heating system with in-floor radiant heating throughout
Black holding tank sprayer
Conveniently placed water pump switches (monitor panel and service bay)
Dual insulated ceiling air ducts with adjustable air vents
Holding and fresh water tanks, radiant-heated
Hookup for city water
MANABLOC® water system
Multiplex coach switching
Onan® 12,500-watt diesel generator with auto-changeover on power sliding tray
Onan® auto generator and temperature start system
Onan® energy command center
Outside shower
Power water hose reel
Surge suppressor
Systems monitor panel
Triple 15,000-BTU low profile central A/Cs with heat pump, digital thermostat, Chillgrille™, and drain tubes
Water purifier at faucet

SAFETY

Carbon monoxide alarm
Deadbolt lock on entrance door
Egress window(s)
Fire extinguisher
Hidden safe
Propane alarm
Lap safety belts in living area
Security system
Smoke alarm
Third brake light
Tire pressure monitor system

OPTIONS

60-watt solar panels (2)
Auto Waste Master™ sewer connection
Black Magnus Opus toilet
Canadian standards
Caramel Glazed Maple hardwood cabinetry
Deluxe entertainment center with hidden 46" LCD HDTV with fireproof ILO sofa
Exterior freezer in slideout tray
Exterior manual solar privacy sunscreen for windshield side windows
Fireplace
Free-standing table with 4 chairs & sofa
Glass mat batteries
Power slide-out cargo tray (2)
Premium Paint Package - Golden Splendor
Premium Paint Package - Molten Metal
Premium Paint Package - Mystic Black
Premium Paint Package - Black Pearl
Premium Paint Package - White Diamond Pearl
Spartan® K3 tag axle chassis with IFS Cummins® ISX 650HP (14.9L) electronic with Allison® 4000 MH 6-speed world transmission & electronic (n/a on 45RB)
Stackable washer & dryer (45DL, 45RB)
Stackable washer & dryer ILO LAV (45SL)

Customer First Roadside Assistance

Travel worry-free in your Cornerstone motorhome with Entegra Coach's Customer First Roadside Assistance program, yours at no cost during your first year of ownership. This program is offered through Coach-Net, the largest RV emergency road service in the country, and gives you immediate access to dependable roadside assistance and support services with a simple phone call.

- Free jump starts
- Free tire changes
- Free fuel delivery
- Free lockout service
- Free travelers checks
- 24-hour toll-free emergency message service
- Toll-free nationwide service appointment assistance
- Free custom trip routing and full-color map service
- Free dispatch of on-site mechanical service
- \$2,000 trip- interruption reimbursement

We Back What We Build

The Entegra Coach Warranty is a manufacturer's limited warranty. It comes from the people who build Entegra Coach products to the people who buy them. Each Entegra Coach is warranted to the original purchaser for twelve (12) months from the original date of purchase (or 12,000 miles of use, whichever comes first) against defects in materials and workmanship. The Entegra Coach Warranty also includes a three (3) year structural guarantee. The Entegra Coach Warranty is not transferable. Our commitment is to provide you with the highest level of products and services possible. We invite you to compare us with other manufacturers – we think you'll find that our passion for your satisfaction is unmatched.

For a copy of the limited warranty with full terms and conditions, ask your local Entegra Coach dealer.

Your Entegra Coach Dealer

See dealer for further information and prices. All information in this brochure is the latest available at the time of publication approval. Entegra Coach reserves the right to make changes and to discontinue models without notice or obligation. Photos in this brochure may show optional equipment or props used for photography purposes. RVs built for sale in Canada may differ to conform to Canadian codes.

© Entegra Coach, Inc.—10-CSTN-PL1009-10K

A reputation for integrity isn't built overnight. It happens only after years of doing what you say you will do...and by practicing the Golden Rule. Ultimately, it involves doing the right thing, even if it isn't the best for your bottom line.

Over the last forty years, our family has worked hard to establish a reputation of integrity in the RV business. Through ups and downs, successes and failures, these four decades have taught us the importance of doing our best to meet our customers' expectations. And that is why we are excited to introduce the finest line of RVs we have ever built – the motor coaches from Entegra Coach.

As our signature line, we believe it captures everything our family and our company have stood for over the years. From its structural quality and old-world craftsmanship, to unmatched customer service, we have never been more pleased to put our name on an RV than we are with the motor coaches from Entegra Coach. We hope you'll take some time with your local dealer to understand why our family stands so strongly behind ***Entegra Coach....Without Compromise.***



ENTEGRA
COACH®



Entegra Coach, Inc., 903 S. Main St., Middlebury, IN 46540, www.entegracoach.com

A Jayco Company