



ENTEGRACOACH®

2010  
ANTHEM



*A Celebration of Design and Craftsmanship*









**ENTEGR A**  
COACH®

## WELCOME TO ANTHEM.

The warmth of solid hardwood cabinetry (shown here in Burnished Glazed Maple) and the lush Ultraleather™ upholstery welcomes you to Anthem, a new Class A motorhome by Entegra Coach. Thoughtful design combined with stylish amenities, like porcelain tile with four-inch inlays and fine Amish craftsmanship, invites you to stay.

Isn't it time you moved up to the Anthem by Entegra Coach?

**You'll appreciate the bathroom's handsome satin nickel faucets, radius walk-in shower with porcelain tile surround and rounded glass enclosure. The tinted skylight will let a little of Mother Nature inside.**



**Anthem's stylish, yet practical, kitchen with beautiful handcrafted solid hardwoods, beveled-edge DuPont® Corian® countertops, Amana® convection microwave and three-burner range top makes meal prep a piece of cake.**





# CELEBRATING LUXURY AND TECHNOLOGY

1. Ultra-Vision™ wrap around one-piece windshield
2. X-Bridge™ frames engineered into the chassis
3. Aluma-Tru™ Superstructure construction on 16" Centers
4. Daytime running lights
5. Deluxe full-body paint package
6. Extra large basement storage
7. Side-hinged baggage doors
8. Slideout storage tray (optional)
9. Frameless tinted dual pane safety-glass windows
10. Flush mounted slideout rooms
11. Rear molded fiberglass cap with high-mounted integrated air intake
12. Porcelain tile with 4" inlays throughout
13. Steel tubular floor joists
14. Wood truss floor risers
15. Floor and underbelly fiberglass Flexfoi® insulation (R-33)
16. 5/8" tongue and groove plywood floor decking



Optional Multiplex™ coach switching puts the control of living area, porch and security lighting at your fingertips.

17. 1/2" foam insulation laminated to sidewall
18. Reflective Flexfoi™ insulation on all 6 sides
19. Sidewall fiberglass Flexfoi® insulation (R-16)
20. Luan board
21. Hi-gloss gel-coat fiberglass exterior
22. Front molded fiberglass cap
23. Welded crowned aluminum truss rafters 16" on center
24. Roof fiberglass Flexfoi® insulation (R-24)
25. 3/8" plywood roof decking
26. Fiberglass roof
27. (2) 15,000-BTU low profile roof A/C with heat pumps and drain tubes
28. Vinyl padded ceiling
29. Entry door with air seal
30. Outside generator slideout tray



Outside, a convenient slideout tray stores the 8.0 KW Onan® diesel generator and glides smoothly in and out for easy access.



For strength and power, the Anthem rests on a Spartan® Mountain Master® tag axle chassis with a Cummins ISL 425 HP electronic engine featuring an Allison® GEN 4 3000 MH six-speed transmission and electronic shifter.





# EXTERIOR GRAPHIC, FABRIC & WOOD CHOICES



*Tuscan Sun*



*White Diamond Pearl*



*Shadow Gray*



Washington Cherry Glazed Maple



Burnished Glazed Maple



Bentley Black



English Elegance



Kensington Place



Stardust

# FLOORPLANS

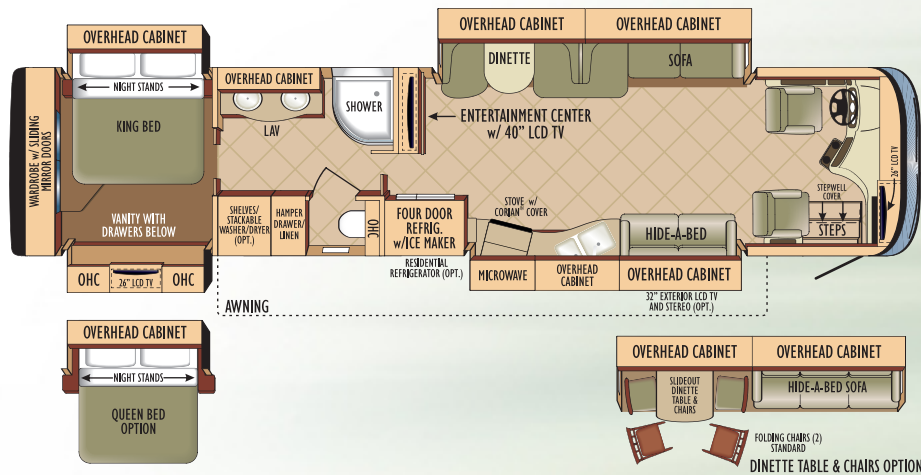

## ANTHEM 42DL

GVWR (lbs.)	44,600	Wheelbase	296"	Capacities	
GCWR (lbs.)	59,600	Overall Length	43' 1"	Fresh Water (gals.)	100
Front GAWR (lbs.)	14,600	Overall Height with Air and Satellite	13' 3"	Grey Water (gals.)	60
Rear GAWR (lbs.)	20,000	Exterior Width	101"	Black Water (gals.)	60
Tag Axle GAWR (lbs.)	10,000	Interior Headroom	84"		



Full-extension ball bearing drawer guides allow the hardwood cabinet drawers to slide easily in and out, while holding up to 75 pounds of weight.

**Gross Vehicle Weight Rating (GVWR):** GVWR means the maximum permissible weight of the motorhome, including the unloaded vehicle weight plus passengers, personal items, all cargo, fluids, options and dealer-installed accessories.

**Gross Combined Weight Rating (GCWR):** The maximum allowable combined weight of the motorhome used as a tow vehicle and the attached towed vehicle.

**Gross Axle Weight Rating (GAWR):** The maximum allowable weight each axle assembly is designed to carry, as measured at the tires, therefore including the weight of the axle assembly itself.

It is important for your safety and enjoyment that you are aware of the weights and tow ratings of the RV you select. Consult a competent advisor if you have questions. Whether you are new to RVing or a veteran, get a feel for the performance of your RV before heading out on the roadways. When you tow a vehicle with your RV, you must drive differently than when you drive a single vehicle. Practice hooking up, driving, backing up and braking in a safe environment or seek our professional instruction. Entegra Coach affixes a weight label to each RV which lists weight information for that vehicle. Refer to that label to verify the vehicle will meet your requirements.

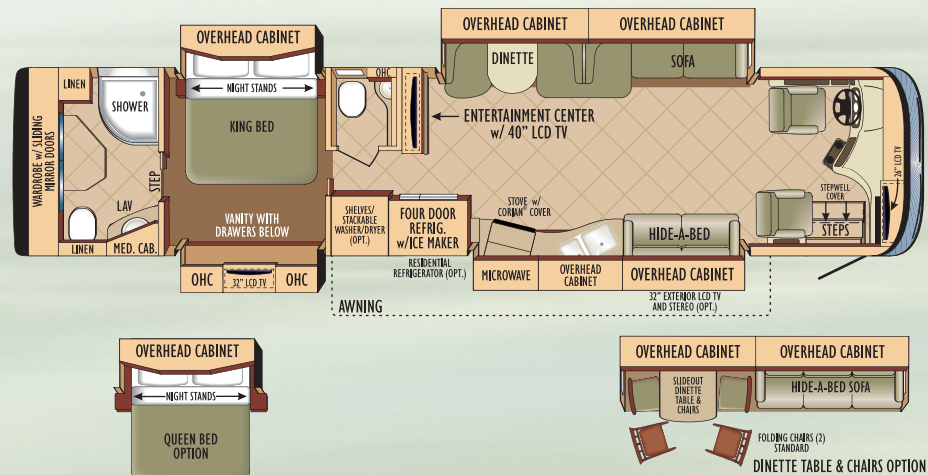

## ANTHEM 42RB

GVWR (lbs.)	44,600	Wheelbase	296"	Capacities	
GCWR (lbs.)	59,600	Overall Length	43' 1"	Fresh Water (gals.)	100
Front GAWR (lbs.)	14,600	Overall Height with Air and Satellite	13' 3"	Grey Water (gals.)	60
Rear GAWR (lbs.)	20,000	Exterior Width	101"	Black Water (gals.)	60
Tag Axle GAWR (lbs.)	10,000	Interior Headroom	84"		

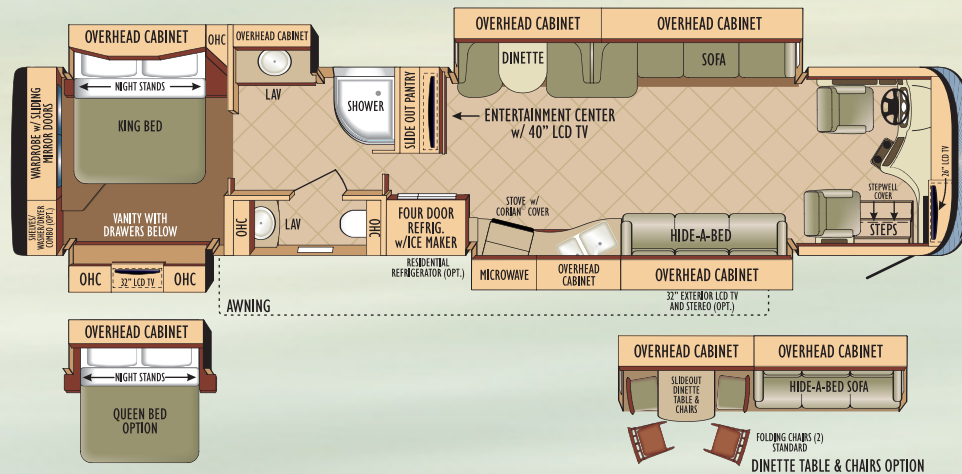

## ANTHEM 44SL

GVWR (lbs.)	44,600	Wheelbase	320"	Capacities	
GCWR (lbs.)	59,600	Overall Length	44' 11"	Fresh Water (gals.)	100
Front GAWR (lbs.)	14,600	Overall Height with Air and Satellite	13' 3"	Grey Water (gals.)	60
Rear GAWR (lbs.)	20,000	Exterior Width	101"	Black Water (gals.)	60
Tag Axle GAWR (lbs.)	10,000	Interior Headroom	84"		



# STANDARDS & OPTIONS

## CONSTRUCTION HIGHLIGHTS

Aluma-Tru™ Superstructure construction on 16" centers  
2" x 4" floor trusses  
2-3/4" welded tubular-aluminum sidewall construction  
3M® front protective film mask  
4-1/2" arched aluminum truss roof (R-24)  
5/8" tongue-and-groove plywood main floor decking  
Cabinetry crafted with screwed hardwood stile construction  
Deluxe hidden cabinet hinges  
Electric-powered slideout  
Enclosed, insulated and heated floor and underbelly (R-33)  
Flush-mounted slideout rooms  
Fully-decked roof with 3/8" plywood  
One-piece fiberglass roof  
Polar Pack insulation with reflective flexfoil floor (R-33),  
roof (R-24), sidewalls (R-16)  
Sidewalls bolted to frame  
Smooth high-gloss gel-coat fiberglass exterior walls  
X-Bridge™ frames engineered into the chassis

## CHASSIS, ENGINE & SUSPENSION

2 chassis batteries  
4.88 "Quiet-Gear" rear axle ratio  
55-degree turning radius  
150-gal. fuel tank (dual fill)  
170-amp alternator  
15,000-lb. hitch with 7-pin plug  
Allison® GEN 4 3000 MH 6-speed shift pad electronic  
transmission  
All-wheel ABS brakes  
Automatic heated moisture ejectors  
Automatic Traction Control (ATC)  
Bilstein® shocks (front/rear)  
Cummins® ISL turbocharged 425 HP engine 1,200 lb. ft  
torque @ 1,300 RPM  
Daytime running lights  
Engine block heater  
Engine compression brake  
Full air front and rear brakes  
Hendrickson HTB™ rear air suspension  
Hendrickson IFS™ front axle 14,600 lb. wide track  
Hendrickson IFS™ independent front air suspension  
Meritor™ rear axle 20,000-lbs., tag axle 10,000-lbs.  
Michelin® 295/80R 22-1/2" radial tires  
Polished aluminum wheels  
Pre-wired for supplemental braking system  
Raised rail for maximum storage  
Remote air fill with air hose  
Side-mounted radiator  
Spartan® Mountain Master® tag axle chassis  
Tag axle auto weight release  
VIP soft touch, wood grain, leather-wrapped steering wheel

## DRIVER COMPARTMENT AMENITIES

12V auxiliary in-dash receptacle (2)  
26" digital LCD HDTV  
AC/heater vents by foot pedals  
Adjustable foot pedals  
Auxiliary start switch  
Battery boost switch  
Chassis battery disconnect  
Color back-up camera and monitor with audio  
Color coordinated carpeted floor mats  
Cruise control (VIP Smart wheel controlled)  
Distressed Ultraleather™ power adjustable driver and passenger  
seats with integrated 3-point, lap and shoulder safety belts  
Fog lights

High-output dash heater and A/C  
In-dash compass and exterior temperature gauge  
Intermittent windshield wipers, single motor (VIP Smart wheel  
controlled)  
Touch-screen AM/FM/CD/DVD with Garmin® navigation  
and Bluetooth® with media and phone integration capability  
Porcelain tile in driver compartment with 4" inlays  
Powered roller side sun visors and privacy shades  
Powered roller sun visors and privacy shades  
Powered stepwell cover with pinch resistance technology  
Powered Ultraleather™ driver and passenger seat  
Push button shift control  
Side cameras with turn signals  
Spartan Message Center with LCD display featuring: odometer,  
tachometer, instantaneous fuel economy, fuel remaining,  
outside air temp., coolant temp., engine oil temp. and  
pressure, transmission temp., turbo boost pressure, air  
pressure, diagnostic functions, fault codes, service  
reminders, percentage of engine load, trip meter, speed  
and voltage  
Storage compartment(s) beside passenger seat  
Tilt and telescoping steering column  
Touch control for hydraulic automatic leveling jack system  
Ultra-Vision™ one-piece wraparound tinted windshield  
VIP smart steering wheel integrated controls for systems

## INTERIOR/ENTERTAINMENT

2-panel residential-style solid hardwood passage doors  
throughout  
40" LCD HDTV in living area  
All-in-one home theater remote  
Ball bearing drawer guides 75-lb. capacity with full-drawer  
extension  
Cable TV hookup with RG6 coax  
Ceiling mirror feature  
Crank-up HDTV antenna with signal booster  
Decorative pillows for comfort lounge and hide-a-bed  
Decorative satin nickel lighting throughout  
Decorative trim package  
Distressed Ultraleather™ booth dinette/comfort lounge sofa  
ensemble  
Distressed Ultraleather™ hide-a-bed sofa  
Fabric and wood-covered box valances with lambrequin legs  
Hardwood cabinets  
Hardwood fascia boards  
High-intensity halogen recessed 12V lighting package  
Home theater system, Dolby® Digital 5.1 Surround Sound with DVD  
Lights at entrance steps  
Padded vinyl ceiling throughout  
Phone jack  
Porcelain tile in living area with 4" inlays  
Power day/night roller shades throughout  
Prep for washer and dryer  
Residential-style trim and molding  
Semi-automatic, roof-mounted, satellite dome  
Washington Cherry Glazed Maple solid hardwood cabinetry  
and mitered corner raised-panel doors throughout

## KITCHEN

120V G.F.C.I.-protected receptacle  
Amana® recessed, sealed 3-burner range  
Amana® 1.6 cu. ft. convection microwave oven with carousel  
Dupont® Corian® bi-fold, recessed cover for stove  
Dupont® Corian® sink covers (2)  
Dupont® Corian® solid surface countertops with integrated sink  
High-rise single-lever faucet  
Mini-blind  
Norcold® 12-cu. ft. 4-door refrigerator with icemaker

Porcelain tile backsplash with tinted glass inlays  
Porcelain tile floor in kitchen with 4" inlays  
Silverware drawer, divided for utensils  
Under-sink, sink cover storage compartment

## BATHROOM

2-panel residential-style solid hardwood passage doors  
120V G.F.C.I.-protected receptacle  
Bathroom power vent  
Dupont® Corian® solid surface countertops with integrated sink  
Overhead cabinet above stool  
Porcelain tile in bathroom with 4" inlays  
Radius-glass shower door with reeded glass design  
Residential medicine cabinet with mirror  
Satin nickel fixtures  
Skylight in shower  
Thetford® porcelain stool with foot pedal  
Toilet paper holder  
Towel holder and ring  
Vanity light fixture  
Window in commode area

## BEDROOM

32" digital LCD HDTV  
All-in-one home theater remote  
Decorative headboard  
Halogen satin nickel reading lights  
Home theater system, Dolby® Digital 5.1 Surround Sound with DVD  
King bed with pillowtop mattress  
Large cedar-lined wardrobe  
Quilted bedspread with 2 pillow shams

## EXTERIOR

120V G.F.C.I.-protected exterior receptacle  
Aerodynamic front cap  
Carefree® armored slideout awnings  
Carefree® armored power entrance door awning  
Carefree® Eclipse™ power awning with polyweave fabric,  
armored side and wind sensor  
CB antenna  
Chrome, heated, remote control, side-view mirrors  
Docking lights  
Door for dump valve access  
Electric-powered, double entrance step  
Entry door with powered air seal technology  
Frameless dual pane tinted safety-glass windows  
Full-body premium paint package  
Full-width rear mudflap  
Hella® driving lamps  
Hydraulic automatic leveling jacks (dual positive)  
Keyless entry key FOB and keypad system  
Lighted heavy-duty grab handle  
One-piece pass-through storage compartments  
Patio light with inside switch  
Rear-molded fiberglass cap with integrated rear intake  
Roof ladder  
Security lights (2)  
Side-hinged baggage doors  
Sliding battery tray (2 position)  
Uni-Dock™ exterior utility center, heated and enclosed with  
second system monitor panel  
Winegard® semi-automatic dome satellite dish.

## HEAT, POWER & WATER

12-gal. gas/electric DSI auto-ignition water heater  
12V demand water pump  
12V electrical system with 120V, 80-amp power converter  
2000-watt inverter with 4-6V batteries

40-gal. propane gas tank, chassis-mounted  
42,000-BTU furnace dual-zone with auto-ignition  
5-watt solar panel (for chassis batteries)  
50-amp electric service  
50-amp, quick-connect power cord with electric reel  
Black holding tank sprayer  
Conveniently placed water pump switches  
Dual 15,000-BTU low profile central A/C with heat pump,  
digital thermostat, Chillgrille™, and drain tubes  
Dual insulated ceiling air ducts with adjustable air vents  
Holding and fresh water tanks, radiant-heated  
Hookup for city water  
Onan® 8,000-watt diesel generator with auto-changeover on  
sliding tray  
Onan® auto generator and temperature start system  
Onan® Energy Command™ center  
Outside shower  
Systems monitor panel  
Water heater bypass system  
Water purifier with faucet and icemaker  
Winterizing kit

## SAFETY

Carbon monoxide alarm  
Deadbolt lock on entrance door  
Egress window(s)  
Fire extinguisher  
Lap safety belts in living area  
Propane alarm  
Security system  
Smoke alarm  
Third brake light

## OPTIONS

22" oven  
3rd 15M A/C with heat pump & 10KW generator  
Air horns  
Aqua-Hot® 450 water & heating system with in-floor heat  
throughout  
Burnished Glazed Maple Hardwood cabinetry  
Canadian standards  
Central vacuum  
Exterior 32" LCD HDTV with CD/DVD player & speakers  
Exterior freezer with slideout tray  
Exterior manual solar privacy sunscreen for windshield  
and side windows  
Fireplace  
Free-standing table with 4 chairs & sofa  
Glass mat batteries  
King Select Comfort™ air mattress  
Multiplex™ lighting  
Power auto rewind water hose  
Power baggage door locks with key fob & touch pad  
Queen pillowtop mattress  
Queen Select Comfort™ air mattress  
Residential refrigerator with ice maker and 2800 sine wave  
inverter & 4 Batteries  
Sirius® radio and tuner  
Slide-out cargo tray  
Premium Paint Package - Tuscan Sun  
Premium Paint Package - White Diamond Pearl  
Premium Paint Package - Shadow Gray  
Stackable washer & dryer (42DL, 42RB)  
Washer/dryer combination (44SL)  
Window awning  
Winegard® in-motion dome satellite dish  
Xenon low beam headlights

## CUSTOMER FIRST ROADSIDE ASSISTANCE

Travel worry-free in your Anthem motorhome with Entegra Coach's Customer First Roadside Assistance program, yours at no cost during your first year of ownership. This program is offered through Coach-Net, the largest RV emergency road service in the country, and gives you immediate access to dependable roadside assistance and support services with a simple phone call.

- **Free** jump starts
- **Free** tire changes
- **Free** fuel delivery
- **Free** lockout service
- **Free** travelers checks
- 24-hour toll-free emergency message service
- Toll-free nationwide service appointment assistance
- **Free** custom trip routing and full-color map service
- **Free** dispatch of on-site mechanical service
- \$2,000 trip-interruption reimbursement

## WE BACK WHAT WE BUILD

The Entegra Coach Warranty is a manufacturer's limited warranty. It comes from the people who build Entegra Coach products to the people who buy them. Each Entegra Coach is warranted to the original purchaser for twelve (12) months from the original date of purchase (or 12,000 miles of use, whichever comes first) against defects in materials and workmanship. The Entegra Coach Warranty also includes a three (3) year structural guarantee. The Entegra Coach Warranty is not transferable. Our commitment is to provide you with the highest level of products and services possible. We invite you to compare us with other manufacturers – we think you'll find that our passion for your satisfaction is unmatched.

For a copy of the limited warranty with full terms and conditions, ask your local Entegra Coach dealer.

### Your Entegra Coach Dealer

See dealer for further information and prices. All information in this brochure is the latest available at the time of publication approval. Entegra Coach reserves the right to make changes and to discontinue models without notice or obligation. Photos in this brochure may show optional equipment or props used for photography purposes. RVs built for sale in Canada may differ to conform to Canadian codes.

**A reputation for integrity isn't built overnight.** It happens only after years of doing what you say you will do...and by practicing the Golden Rule. Ultimately, it involves doing the right thing, even if it isn't the best for your bottom line.

**Over the last forty years,** our family has worked hard to establish a reputation of integrity in the RV business. Through ups and downs, successes and failures, these four decades have taught us the importance of doing our best to meet our customers' expectations. And that is why we are excited to introduce the finest line of RVs we have ever built – the motor coaches from Entegra Coach.

**As our signature line,** we believe it captures everything our family and our company have stood for over the years. From its structural quality and old-world craftsmanship, to unmatched customer service, we have never been more pleased to put our name on an RV than we are with the motor coaches from Entegra Coach. We hope you'll take some time with your local dealer to understand why our family stands so strongly behind *Entegra Coach....Without Compromise.*



ENTEGRA  
COACH®



Entegra Coach, Inc., 903 S. Main St., Middlebury, IN 46540, [www.entegracoach.com](http://www.entegracoach.com)

A Jayco Company